

110 Yallambee Road BEROWRA NSW

4  1  4 

Set in a leafy area close to the National Park, freshly painted and new carpeted property is well worth a look.

It will lend a hand to a diversity of family needs

Consisting of:

- Large main living area
- Modern upgraded kitchen and appliances
- Floorboards through kitchen and family room
- 4 bedrooms all with built in robes
- Timber deck flowing from family area
- Double lock garage, carport, garden shed
- Rear access to yard for vehicles
- Plenty backyard room on 1,018sqm

- Peter McDonagh
peter.m@mcdonaghblake.com

0410587856

- Steve Piperitis
0417020430 steve.p@mcdonaghblake.com

Land Size : 1018 sqm

View : <https://www.mcdonaghrealestate.com.au/sale/nsw/north-shore-upper/berowra/residential/house/7473739>



Peter McDonagh
0410587856

110 Yallambee Road, Berowra

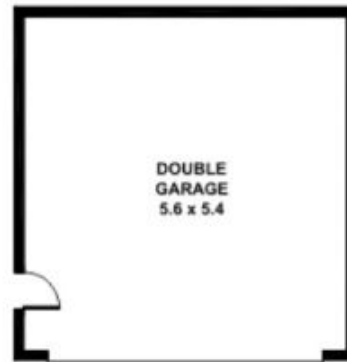

NOT IN CORRECT POSITION



Please note: All stated dimensions are approximate only. Particulars given are for general information only and do not constitute any representation on the part of the vendor or agent.

