





2 Wanganella Close MOUNT COLAH NSW

3  2  3 

Privately nestled in a hushed, tightly held cul de sac, and poised to enjoy a bright northerly aspect to the rear, this attractive exudes family friendly warmth across a spacious floor plan is geared for flexible living. It's easy to forget that every convenience is within strolling distance from this serene Mt Colah pocket.

The freshly painted deck presents the dwelling in excellent condition. L-shaped living and dining introduces the welcoming interior with floorboards and premium, practical finishes that include a combustion log fireplace.

Entertainers will delight in the stylish near new kitchen with quality stainless appliances that include a fully ducted range hood, dual drawer dishwasher, and De'Longhi oven. The large walk-in pantry is a rare asset, and the breakfast

Type : House
Building Size : 27 sqm
Land Size : 594 sqm
View : <https://www.mcdonaghrealestate.com.au/sale/nsw/north-shore-upper/mount-colah/residential/house/7473736>



Peter McDonagh
 0410 587 856

[For full version visit the website](https://www.mcdonaghrealestate.com.au)

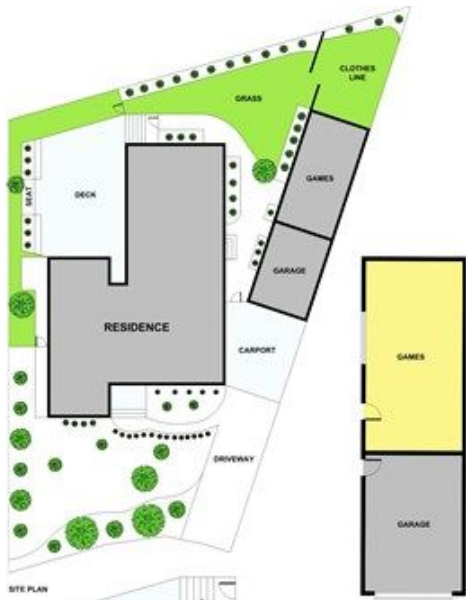

SITE PLAN

